

XL series New Audio Rack

The latest sophisticated and elegant design rack system. These revolutionary structure shelf boards, pillar with casting iron parts, and new legs have respectively vibration dumping beyond the class.

New! 1 The revolutionary original construction shelf board design.

- The shelf board contains oscillation controlling sheet inside for more clear sound.
- The latest construction enhances oscillation dumping as much as top class series.
- The design is based on wood grain and has elegant and modern form.

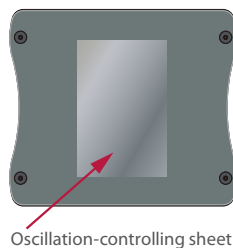

Oscillation-controlling sheet

New! 2 New Vibration dumping "FC separate system"

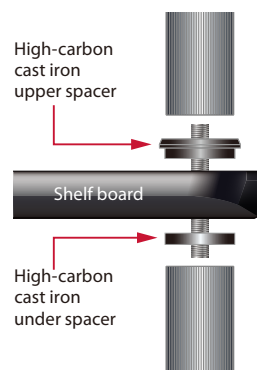

- The system is one of the ideal techniques for audio rack we achieved through developing CSR rack as our best audio rack and a lot of researches.
- Placing each cast iron spacer on the top and bottom of the pillar enhances separation between shelves effectively.
- Each spacer is carefully designed and tunes the best balance of vibration dumping for audio.

FC (Ferrum casting) is whole symbol of casting iron.

New! 3 New High-carbon cast iron Spike & Plate



- These spikes & plates enhance high frequency S/N and resolution from low frequency sound to middle frequency sound dramatically.
- The spike is machined putting the feeling of material of cast iron and has stability and oscillation dumping.
- The spike plate is also made of cast iron and the shape is reminiscent of grand piano insulator.
- The spike plate has deep hole to prevent falling when moving to side.

New! 4 Improving image quality with vibration dumping

- TAOC's vibration dumping improves not only sound quality but also image quality at your home theater environment.

- Sound resolution and S/N are improved clearly.
- Sharpness of image quality is enhanced dramatically.

XL series Standard

S Type Color variation **WD** Dark Wood **WL** Light Wood

XL-1S-WL/WD

● Weight: 8kg ● Load capacity: Up to 100 kg per shelf

XL-2S-WL/WD

● Weight: 13kg ● Load capacity: Up to 100 kg per shelf

XL-3S-WL/WD

● Weight: 19kg ● Load capacity: Up to 100 kg per shelf

XL-4S-WL/WD

● Weight: 25kg ● Load capacity: Up to 100 kg per shelf

XL-5S-WL/WD

● Weight: 30kg ● Load capacity: Up to 100 kg per shelf Up to 400 kg for the entire rack

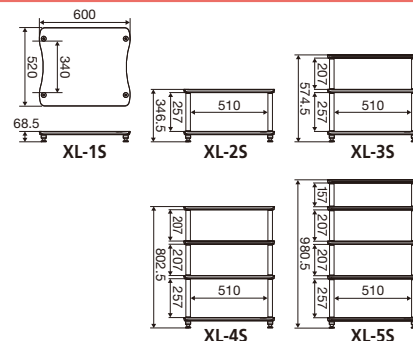
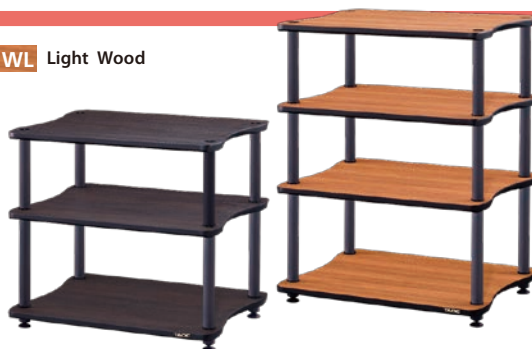

L Type Color variation **WD** Dark Wood **WL** Light Wood

XL-1L-WL/WD

● Weight: 13kg ● Load capacity: Up to 200 kg per shelf

XL-2L-WL/WD

● Weight: 24kg ● Load capacity: Up to 200 kg per shelf

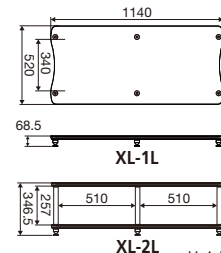

Unit: mm

XL series Customiz

Combine additional units with our basic set to suit your needs in term of your preferred shelf board spacing and the number of shelf boards you need.

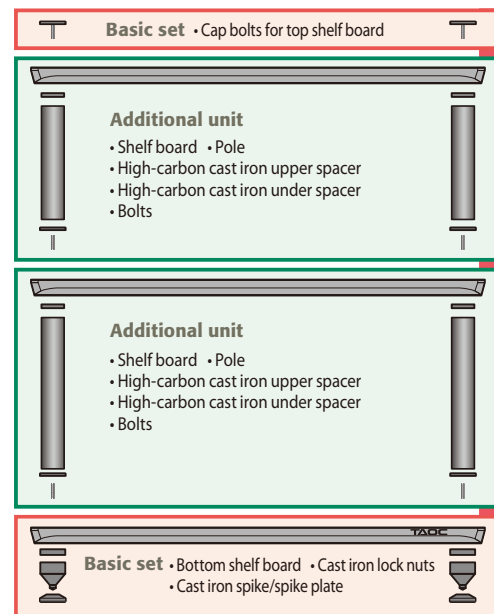

▲The above is a combination example of CL series 3 shelves rack.

Order to make your original audio rack

1. basic set model among each one shelf type.
(XL-1S-*/1L-*)



2. Combine additional unit from the list as much as necessary.

- Length of pole is available from 100 to 350mm.
- Standard model and customized rack are same price in same number of shelf board and pole.
- Combination of different size shelf is available. (Ex. S size on L size)

Note 1) The "L" dimension of additional units represents the shelf board spacing. Please choose the spacing you prefer.

Note 2) To ensure stability we recommend that the rack height not exceed 150cm. The rack's total load-bearing capacity is 400kg.



Additional Unit

Model number

Series **XL-F410-WL** Color
The number of pole Pole length

Set Unit(one Shelf)

- shelf board • Pole
- High-carbon cast iron upper spacer
- High-carbon cast iron under spacer
- Bolts

S type

XL-F410-WL/WD <L:100mm>
XL-F415-WL/WD <L:150mm>
XL-F420-WL/WD <L:200mm>
XL-F425-WL/WD <L:250mm>
XL-F430-WL/WD <L:300mm>
XL-F435-WL/WD <L:350mm>

L type

XL-F610-WL/WD <L:100mm>
XL-F615-WL/WD <L:150mm>
XL-F620-WL/WD <L:200mm>
XL-F625-WL/WD <L:250mm>
XL-F630-WL/WD <L:300mm>
XL-F635-WL/WD <L:350mm>

L: It means pole length.
The shelf board spacing is 7mm longer than it.

XL series Options

Pole • Finish: Black metallic • Diameter: 30mm

for CL-S type (set of four)



<L: It means pole length.>

for CL-L type (set of six)

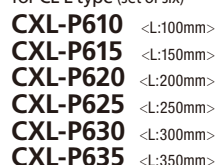

Caster

- Static load-bearing capacity: 100kg per caster
- Caster diameter: 60mm (Attached dimension: 65mm)



CS-120(4 per set)

CS-123(6 per set)

Cast iron joint

* required when using caster(CS-120,123)



XLP-100
(Set of four use with CS-120)



XLP-101
(Set of six use with CS-123)

AISIN TAKAOKA CO., LTD.

1 Tenno, Takaokashinmachi, Toyota-City,
Aichi Prefecture, Japan, 473-1181
Telephone:+81-565-54-1272
<http://www.taoc.gr.jp>

⚠ Caution! TAOC products are heavy. Use caution when handling these products. Always make sure to read the Instruction Manual before use.

* Specifications and external designs may be modified without prior notice. * Due to the photography and the printing inks used, the colors shown here may differ from the actual colors.